

MICHIGAN'S WOMEN OF THE LIGHTS

Over 250 women have served as keepers of lighthouses along the coasts of the United States. Most of the women inherited the jobs after their fathers or husbands were no longer able to do the work. Because of the efforts and bravery of many of these women, the Lighthouse Service eventually began to hire female lightkeepers.



The first woman lightkeeper was Hannah Thomas. She became the lighthouse keeper at Gurnet Point on Plymouth Bay, Massachusetts in 1768. The last woman to hold the position was Fannie Salter. She kept the Turkey Point Light on the Chesapeake Bay from 1925-1947.

During the period from 1855-1926, the following 17 women served as lightkeepers along the coastlines of the Great Lakes.

Julia Toby Brawn: Bay City, 1873-1890
 Annie M. Carlson: Granite Island, 1903-1905
 Anna Garraty: Presque Isle, 1903-1926
 Sarah E. Lane Grand: Mission Point, 1906-1908
 Julia Ann Griswold: Eagle River, 1861-1865
 Mrs. Donald Harrison: St. Mary's River, 1902-1904
 Carolyn Litigot: Mamajuda, 1874-1885
 Kate Marvin: Squaw Point, 1897-1904
 Annie McGuire: Pentwater, 1885

Catherine McGuire: Thunder Bay, 1882-1891
 Mrs. William Monroe: Muskegon, 1862-1871
 Catharine Shook: Pointe aux Barques, 1849-1851
 Lydia Smith: Manitou Island, 1855-1856
 Mary Terry: Sand Point, 1868-1886
 Eliza Truckey: Marquette, 1862-1865
 Mary Vreeland: Gibraltar, 1879
 Elizabeth (Van Riper) Williams: Beaver Island and Little Traverse, 1872-1913

WOMEN LIGHTKEEPERS ON THE GREAT LAKES

Use the information above and a Michigan map to answer the following questions:

1. Which lightkeeper served the longest term as a lightkeeper? _____
How long did she serve? _____
2. What famous historical event occurred during the terms of Eliza Truckey and Julia Griswold that may have made it necessary for them to take over the job for their husbands? _____
3. Name the lighthouse and the keeper who served in the most northern lighthouse?

4. Name the keeper and the lighthouse located at the tip of the thumb area of Michigan?

5. What is the span of years between the first woman lightkeeper and the last?

Who are they? _____ and _____

MICHIGAN'S WOMEN OF THE LIGHTS PROJECT

1. Make a lighthouse tower using direction numbers 2-5 from "Building A Lighthouse." project on page GL 86 of the L.A.P.'s™ Great Lakes Unit.
2. Choose one of the names from the list of Michigan's women lightkeepers.
3. Cut out and color the character below and put the woman's name, the location of her service and her years of lighthouse service in the box.
4. Attach a popsicle stick or tongue depressor to the back of the character as shown below, taping it only at the top part of the character.
5. Cut two slits in the lighthouse tower about 1 inch apart as shown.
6. Put the stick under the top slit on the lighthouse tower and out the bottom slit to hold the character in place.
7. Using a large wall map of Michigan as the bulletin board background, attach each of the lighthouse towers to the proper location on the map.

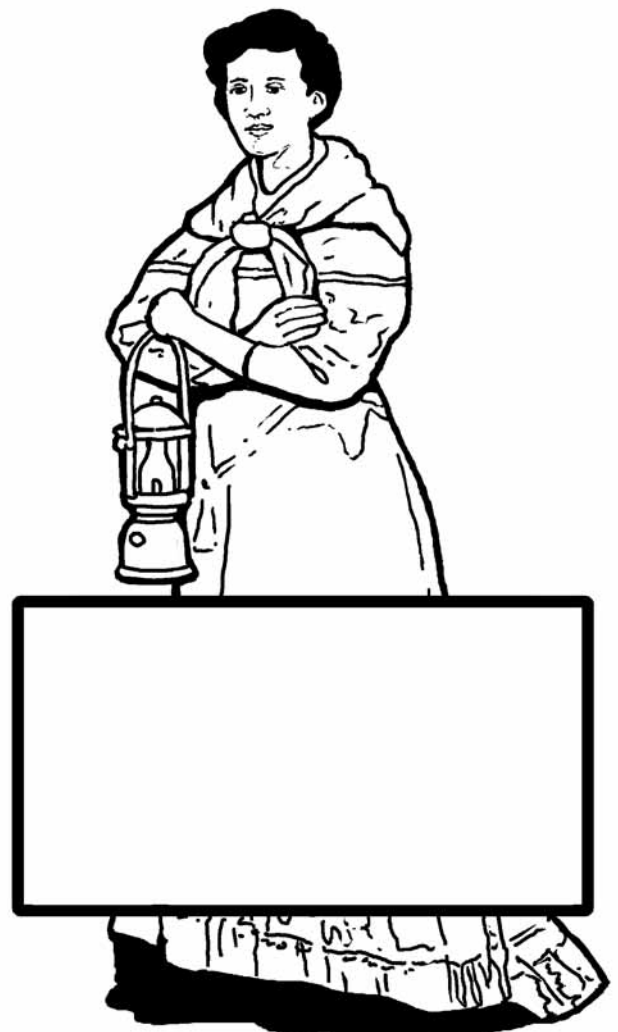
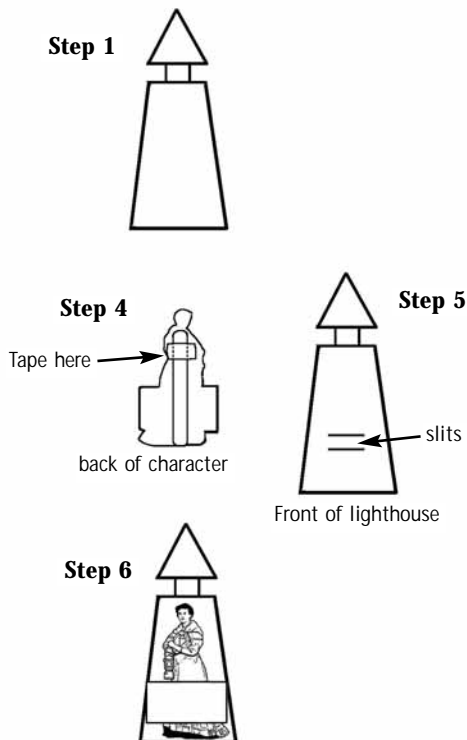

Other Ideas:

1. Use the map on page 4 of the L.A.P.'s™ Student Booklet to find the latitude and longitude of each of the lighthouses.
2. Make a **FOLD AND CUT CHARACTER** (found in L.A.P.'s™ program page DNR 34) for one of the woman keepers and write a short biography on the inside.

MICHIGAN'S HISTORIC LIGHTHOUSES



Use the lighthouse map on the back of the L.A.P.'s™ Great Lakes student page, a Michigan map and the latitude and longitude map found on page 4 of the Michigan L.A.P.'s™ Student Booklet to answer the following questions.

1. The lighthouse located at the tip of the Leelanau Peninsula is _____.
2. Which Michigan lighthouse is the farthest north?

3. Which lighthouse is located on an island in Saginaw Bay?

4. Which lighthouse is closest to Mackinac Island? _____
5. Which lighthouse is located closest to Fayette Historic State Park?

6. Which four lighthouses are located closest to Isle Royale?

7. Which lighthouse is near the famous shipwreck *Edmund Fitzgerald*?

8. Which two lighthouses are located approximately 42 degrees north latitude?

9. Which Michigan lighthouse is the farthest south?

10. Give the approximate latitude and longitude for the Manning Memorial Light located just southwest of Traverse City.

OTHER IDEAS FOR USING THE LIGHTHOUSE MAP:

1. Choose a lighthouse to research. Write a report based on the information.
2. Imagine that you are a lightkeeper. Write a week-long journal of your daily activities.
3. Choose one of the lighthouses. Write a fiction or non-fiction story about a shipwreck that happened nearby.
4. Research the life of a Michigan lightkeeper. Make a Fold-and-Cut Character of the lightkeeper and write your report inside. (The directions for making a Fold-and-Cut Character can be found on page HP 2 and CAP 9 of the L.A.P.'s™ Program.)